

ENDURE SHOCKER

Volume 2/Issue 6

June 2015

Endure ELECTRIC LTD

#8, 240040 Frontier Pl SE
Calgary, AB, T1X 0N2

P: 403.457.4212
F: 403.457.4112

info@endureelectric.com

Solar Energy for your Electricity

Consider these great facts about solar power:

One of the cleanest sources of energy since it doesn't produce any by-products or pollutants.

One of the best sources of renewable energy since it is from the sun, unlike fossil fuels which are considered a non-renewable resource.

There are many methods for harnessing and using solar energy including the popular photo-voltaic cells, or solar panels.

Aside from the initial cost of solar panel installation, solar energy is completely free and is found in abundance and it is infinitely reliable.

Each day, the earth receives about 1366 watts of direct solar radiation per square meter.

Solar panels, once installed, are virtually maintenance free and their batteries last for years.

Source: www.conserve-energy-future.com

We've Moved!

Many preparations for the big day have been under way for several months now, and the time is finally here!

Back in November work began on the development of our new office bay located at #8, 240040 Frontier Place in the city's Southeast.

Much has been accomplished since then! After all the hard work and dedication to the project, our contractor has done a fabulous job at getting our new space move-in ready.

With a finished upper level and larger warehouse, the office will give us plenty of room to grow. We are looking forward to a bright future with expansion on the horizon.

The new space boasts a large lighting area showcasing Lutron and other top of the line electrical products and their functionality. This will make it easier for clients to see the potential for lighting design in their homes and other projects.

Blossoms in June

Hooray for sunny days, golf, summer sports, and family BBQ night! June is here and the summer is looking wonderful ahead!

There is still time to plant a garden if you haven't already. Many root vegetables do well in our short growing season and often green houses have ready-to-plant varieties of tomatoes,



Photo credit: calgaryherald.com

peppers, and strawberries.

Bee friendly gardens, plants, and trees are becoming very popular with the steady decline of the

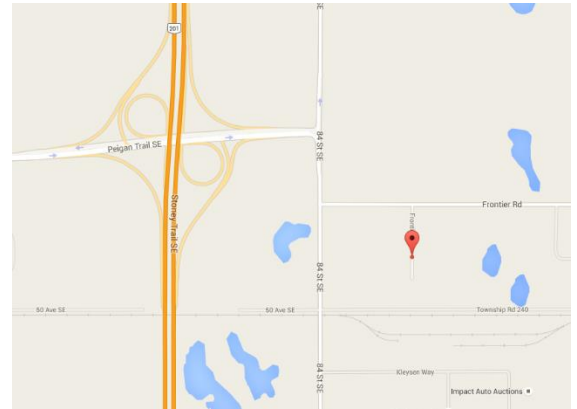

To access our new location, it is easiest to use Stoney trail and travel to the Peigan Trail exit. Head East on Peigan Trail and go to the right (South) at 84th Street SE. Once you are on 84th Street, take the first left onto Frontier Road and then your first right onto Frontier Place.

The large commercial building on the left (East) is where you will find our bay. There are no overhead signs for businesses, so keep a keen eye on the doors for bay #8 and our Endure Electric Ltd logo.

bee population. Bees play an important role in the healthy pollination of blooming plants including fruit trees, vegetables, and of course our flower gardens.

For more information on how to promote a healthy, "bee friendly" yard, Google it or for some great ideas visit www.davidsuzuki.org and search "bee friendly" to find the article called "Create a bee-friendly garden".

The Winner's Circle!

This month's Employee recognition draw winners were:

- 3rd place draw: Nick
- 2nd place draw: Julian
- 1st place draw: Kyle

Great work everyone! Your dedication and effort is appreciated!

Birthdays This Month

Chris
Shane

Crew Updates

Thank you to all of our staff for the help, patience, and support while we prepared for and moved to our new location! Here's to a smooth process as we continue through 2015!



Wiring for an Appliance Garage

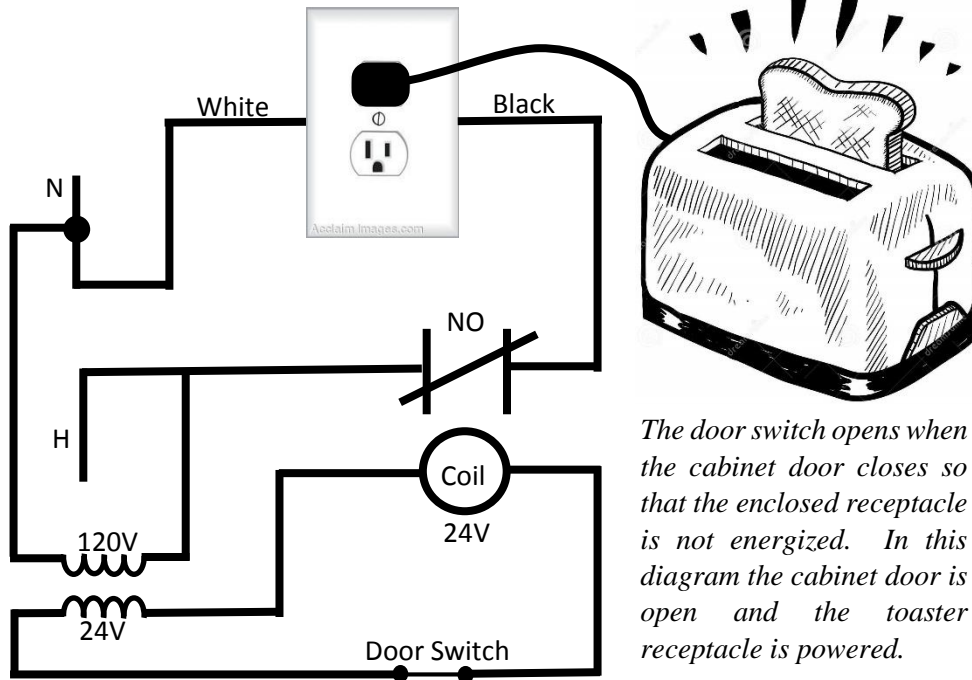

The door switch opens when the cabinet door closes so that the enclosed receptacle is not energized. In this diagram the cabinet door is open and the toaster receptacle is powered.

Code Rules on Appliance Garages

The Canadian Electrical code is very specific about receptacles for residential occupancies when it comes to having a receptacle in an enclosed space such as a closet, cupboard, or cabinet.

Under 26-710 the 2015 23rd Edition states that:

(h) a receptacle shall not be placed in a cupboard, cabinet, or similar enclosure, except where the receptacle is

- i. an integral part of a factory-built enclosure;
- ii. provided for use with a specific type of appliance that is suitable for installation within the enclosure;

- iii. intended for a microwave oven;
- iv. intended only for a cord-connected range hood; or
- v. intended only for a cord-connected combination microwave oven/range hood fan;

(i) except for cord-connected dishwashers, in-line water heaters, garbage disposal units, and other similar appliances, receptacles installed in cupboards, cabinets, or similar enclosures in accordance with item (h)(ii) shall be de-energized unless the enclosure door is in the fully open position.

Remember, no inspection will pass on an enclosed receptacle that doesn't have a properly installed door activated sensor.

Other News

Not only do we have the big news of our move, but this past month we also started a couple of other projects.

Currently our website is being updated and re-launched. It will have a sleek new interface, easy navigation, and a modern design. We'll keep you posted on when it will be available for you to check out yourself!

We've also hired a new Occupational Health and Safety consultant to assist us in ensuring that our company is operating safely and meeting all provincial and national OHS regulations and standards.

Report from the Field

It's always great when we hear from our customers about their appreciation for the electrical work they had done and it's even better when we hear that our electrician went above the call to ensure the customer's satisfaction.

This week we received a great report about an out-of-the-way trip Dave made to complete a project. The customer said that "he was very

helpful ... he is a credit to your company and a great young man!!"

Way to go Dave!



Core Values

We take pride over the many aspects of our company and expect it to be evident in the interaction each of our clients, customers, and the public has with our employees.

The layout of the warehouse at the new shop has allowed us to outfit the back wall with a large mural depicting our core values and what they stand for.

This not only stands as a reminder to each employee, field staff or office staff, what we stand for, but it is also a method of accountability since anyone who enters the warehouse can very obviously see it – including clients, sales representatives, and guests.

Professional:

We are proficient in all dealings with stakeholders, customers, co-workers, and members of the public

Resourceful:

We approach every project with a positive attitude and continually seek ways to improve our methods in order to provide the best solutions for our customers

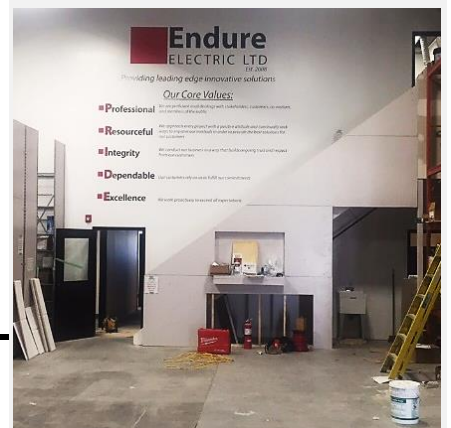

Integrity:

We conduct our business in a way that builds ongoing trust and respect from our customers

Dependable:

Our customers rely on us to fulfill our commitments

Excellence:

We work proactively to exceed all expectations